

GTO/PRO[®]

AUTOMATIC GATE OPERATORS

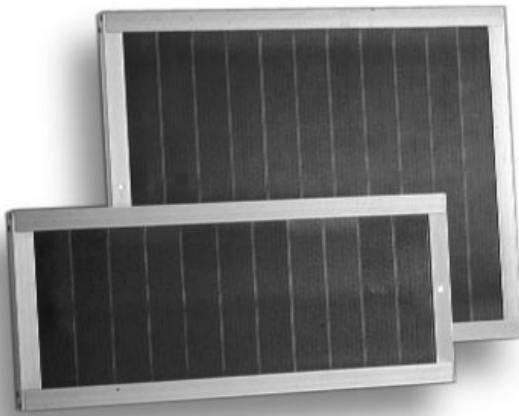

Accessories



ACCESS-ories



GTO Digital Keypad (F300)

The specially designed weatherproof digital keypad can be easily installed as a wireless or wired keypad for swing and slide gate operators, or as a wired keypad for the Bulldog Pedestrian Gate Lock. It can be programmed to use up to fifteen different personal identification number (PIN) codes. Each code is face programmable with additional security features built in. Requires 3 AA batteries (not included). Can also accommodate most garage doors and other gate openers. If used as a wired keypad, GTO low voltage, 16 gauge, dual conductor, multi-stranded, direct burial wire will be required.

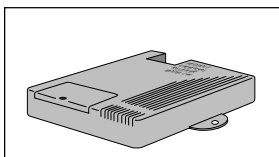

Garage Door Receiver (RB709)

Allows the use of the same **GTO** remote transmitter (see Dual and Triple Transmitters) to control the gate operator and garage door opener. Compatible with most garage door openers.

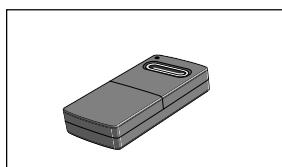

GTO Entry Transmitter (RB741)

The **GTO** Entry Transmitter, with adjustable code settings is standard equipment with all GTO gate operator systems. Battery included.

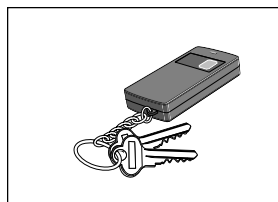

GTO Key Chain Mini Transmitter (RB744)

The Key Chain Mini Transmitter is a miniature version of the **GTO** entry transmitter and has the same adjustable code settings. Battery included.

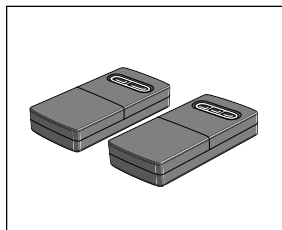

GTO Dual Transmitter (RB742) GTO Triple Transmitter (RB743)

The two and three button transmitters are used for the remote control of two or three gate operators and/or garage door openers (See Garage Door Receiver). Battery included.

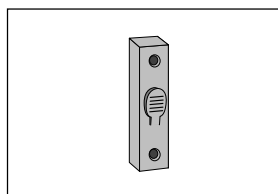

Push Button (doorbell) Control (RB101)

Unlit doorbell button for remote entry or exit control. Wires directly to the control board using 16 gauge, stranded, direct burial, low voltage wire (not included).

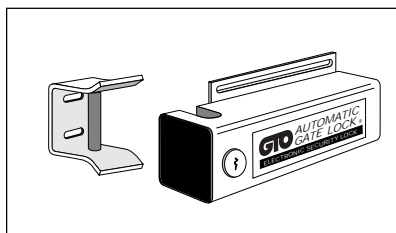

GTO Automatic Gate Lock (FM144) for closed position pull-to-open applications

A **MUST** for added security. Driven by a 4 amp solenoid, the plated steel bolt lock has a zinc plated steel housing. The horizontal electronic lock is used with all GTO swing gate operator systems for additional security and stability. Comes with a keyed manual release.

GTO Automatic Gate Lock (FM142) for open position or push-to-open applications

Similar to FM144 but used to secure gates in the open position, or for push-to-open gate applications (not shown).

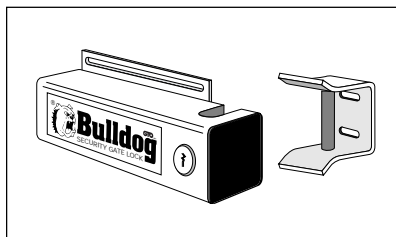

GTO Bulldog Pedestrian Gate Lock (FM500)

Similar to the Automatic Gate Lock but designed for horizontal use only on "**walk-thru**" gates without automatic operators. The Bulldog is an affordable solution to protecting swimming pool areas, playgrounds, tennis courts, boat docks, etc., from unwanted access. Includes control box and keyed manual release.

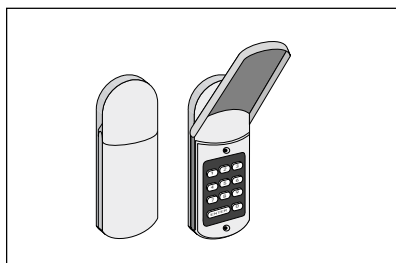

Bulldog Digital Keypad (RB711)

The weatherproof digital keypad for the Bulldog Pedestrian Lock has an adjustable six digit code. Installation is easy, using standard low voltage wire. The Bulldog control box is pre-wired for this keypad accessory. Not for use with automatic gate openers

ACCESS-ories

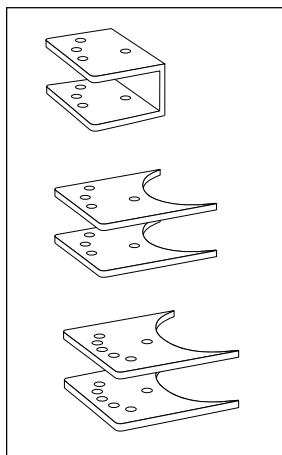

4" (O.D.) Post Bracket (RB464)
Recommended for mounting GTO/PRO 2000 to a 4" gate post.

4" (O.D.) Round Post Bracket Adapters (RB469)

These adapters are necessary when mounting the 4" post bracket to a 4" (O.D.) gate post. **Two required for each gate.** Use with 4" Post Bracket (RB464).

6⁵/₈" (O.D.) Round Post Bracket Adapters (RB467)

Similar to RB466, used with 6⁵/₈" (O.D.) gate post. **Two required for each gate.**

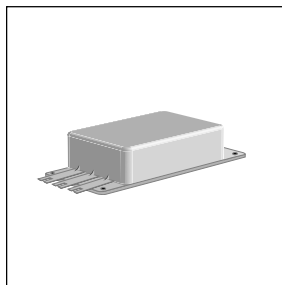

Replacement Receivers

The **AQ201**: Receiver with a 10 ft. cable (included).

The **AWQ325**: Receiver with a 25 ft. cable.

The **AWQ350**: Receiver with a 50 ft. cable.

The **AWQ400**: Receiver with a 100 ft. cable.

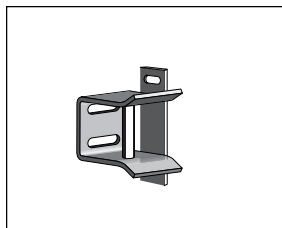

Column Mount Lock Receiver (433IH)

For mounting the **Automatic Gate Lock** or **Bulldog Pedestrian Lock** on areas with limited space between the gate and post, such as brick columns, walls, etc.

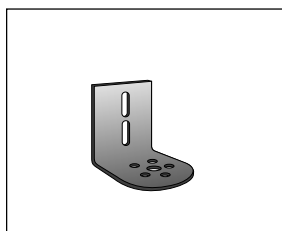

Column Mount Bracket (349IH)

For column installation of the GTO/PRO 1000 series operators. Designed for mounting the Post-Pivot Bracket on masonry columns or any flat surface. **Two Brackets are required for each operator.**

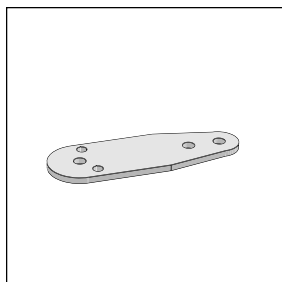

Push To Open (FM305)

Required when **GTO/PRO 1000** series gate operator(s) must push the gate open, such as on a sloping driveway or where space prevents gate(s) from opening inward (pulled open). **Order two PTO kits for conversion of a dual swing gate installation.**

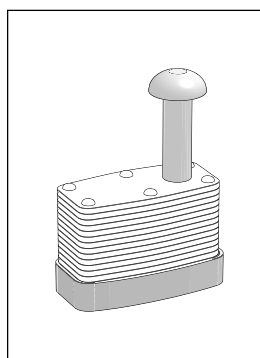

Master® Pin Lock (RB975)

The pin lock substitutes for the clevis pin at either or both mounting points of the GTO/PRO 1000 series operator arm. Helps prevent theft of the operator arm while allowing quick release of the operator.

The pin lock can be inserted in the chain brackets of the GTO/PRO SL-1000 to prevent unauthorized removal of the quick release pins.

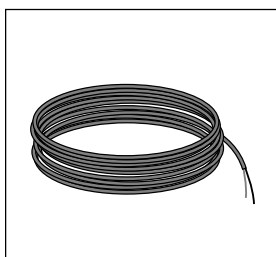

GTO Low Voltage Wire (RB509)

The 16 gauge, dual conductor, multi-stranded, direct burial, low voltage wire is required to connect the control board to either the solar panel or the AC transformer. This wire is also required for installation of some accessories such as keypads, locks, or push buttons.

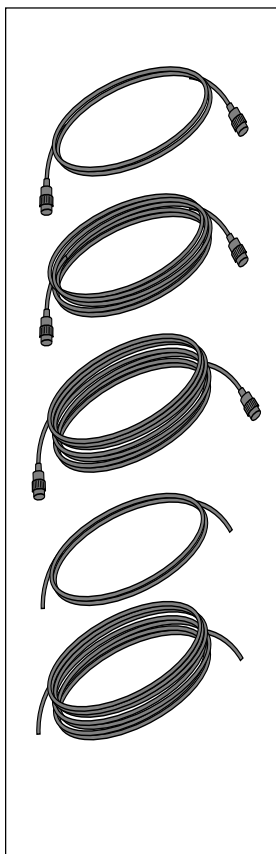

Standard Replacement Power Cables for Gate Operators

The **PRO 4.5C (AW203)**: 4.5 ft. power cable included with **GTO/PRO 1000** or **GTO/PRO 1800** single gate operators.

The **PRO 25C (AW204)**: 25 ft. power cable included with **GTO/PRO 1200** dual (second) gate operator.

The **PRO 35C (AC108)** and **PRO 40C (AC109)**: 35 and 40 ft. "Quick Connect" power cables for GTO/PRO 1000 series operators; allow the control box to be mounted in a more remote location, away from the gate.

The **PRO 6C (AW209)**: 6 ft. power cable included with **GTO/PRO 2000** single gate operators.

The **PRO 50C (AW210)**: 50 ft. power cable included with **GTO/PRO 2200** dual (second) gate operator.

The **PRO 60C (AC202)**: 60 ft. Power cable included with GTO SL-1200 dual (second) slide gate operator.

ACCESS-ories

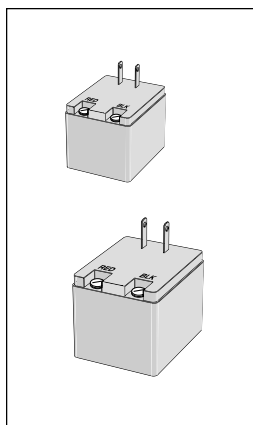

Standard Replacement Transformer

RB502 – Standard 14 volt AC transformer for maintaining the battery included with the **GTO/PRO 1000** gate operator.

RB418 – Standard 18 volt AC transformer for maintaining the battery included with the **GTO/PRO 1800** gate operator.

Heavy Duty Replacement Transformer

RB419 – Heavy Duty 14 volt AC continuous cycle duty transformer (see wire chart in installation manual) for maintaining the battery included with the **GTO/PRO 2000** and **GTO/PRO SL-1000**.

Bulldog Replacement Charger

RB421 – Standard 12 volt DC charger (not shown) for maintaining battery included with the Bulldog Pedestrian Gate Lock.

These are the only transformers approved for use with the **GTO/PRO** gate operators. For older model operators, call for assistance.

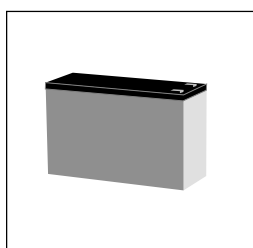

Replacement Battery (RB500)

The standard 12 volt, 7.0 amp-hour, maintenance-free battery for all **GTO/PRO** gate operators. This battery is the only battery approved for use with **GTO** Operators. Life expectancy is 3-5 years.

Replacement Battery (RB506)

The 6 volt, 7.0 amp-hour version for use in the **GTO/PRO 1800** power system in conjunction with 12V battery (RB500).

Replacement Battery (RB422)

The 12 volt, 1.2 amp-hour version for use with the Bulldog Pedestrian Gate Lock.

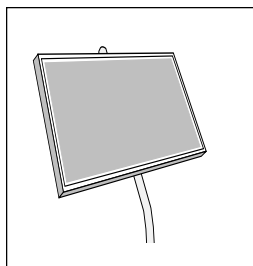

Operator Solar Panel (FM123) - Improved, Amorphous Silicon (Two Year Warranty*)

This 10 watt solar panel is a solar powered battery charger for use with **GTO/PRO Automatic Gate Operator** systems. Particularly suited for remote installations, the solar panel comes with tubular steel support, mounting clips, wire connectors, and 8 ft. of low voltage wire. (See Low Voltage Wire for additional wire.) Installation in some regions of the world will require multiple panels for adequate charging power. Recommended for **GTO/PRO 2000/2200, GTO/PRO SL-1000/SL-1200** and **GTO/PRO 1800**.

Dual gate installations require minimum of two (2) FM123 solar panels for adequate charging power.

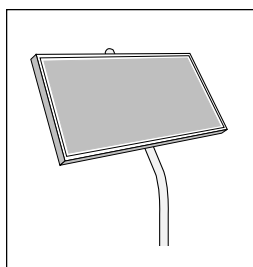

Operator Solar Panel (FM122) - Improved, Amorphous Silicon (Two Year Warranty*)

The 5 watt solar panel is a solar powered battery charger for use with **GTO/PRO Automatic Gate Operator** systems. Particularly suited for remote installations, the solar panel comes with tubular steel support, mounting clips, wire connectors, and 8 ft. of low voltage wire. (See Low Voltage Wire for additional wire.) All operators are pre-wired for the solar panel. Installation in some regions of the world will require multiple panels for adequate charging power. Recommended for **GTO/PRO 1000, GTO/PRO 1200** and **GTO/PRO 1800**.

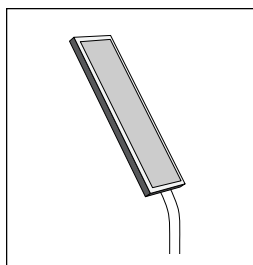

Bulldog Solar Panel (FM501)

The **GTO Bulldog** solar panel is a solar powered battery charger for use with the Bulldog Pedestrian Gate Lock system. Particularly suited for pool areas where AC power is not preferred. The **GTO Bulldog** solar panel comes with tubular steel support, mounting clips, wire connectors and 20 feet of low voltage wire. The Bulldog control board is pre-wired for this solar panel accessory.

** GTO, Inc. gate operator accessories are warranted by the manufacturer against defects in materials and workmanship for a period of one year, unless otherwise stated, from the date of purchase provided recommended installation procedures have been followed. Warranty is considered void if damage was due to improper installation or use, connection to an improper power source, or was caused by lightning, wind, fire, flood, insects or other natural agent.*